

Plants are an integral part of the garden – they bring life, colour and aroma to hard landscaping and offer endless possibilities of change, not only through the seasons but also by offering a chance to update your garden through colour and structure as styles and trends change.

You may not see any plants in our store but we have thousands ready and waiting at our chosen nurseries. These are managed by plant specialists who are also qualified garden designers.

How can we help you?

For homeowners, we offer three services:

- 1.** We can arrange for a Garden Designer to come to your home and work with you to create the garden of your dreams. This will include a planting plan which will specify which plants would be appropriate for your garden, taking into account the soil type, the amount of light and shade and drainage throughout the garden. The planting plan will be supplied in the form of an overlay on your garden design identifying exactly which plants should be planted where, specifically concentrating on the type of plant, its shape and height. We can even plant the plants for you if you choose our 'installation' option.
- 2.** Alternatively, if you wish to transform your garden yourself and would simply like a little bit of advice as to what you should plant and where, we offer simple planting packages with plants, care instructions and guidance. These planting packages have been created to sit alongside the 10 garden styles displayed throughout the store. For example, if you are recreating a touch of the Mediterranean within your garden we can provide you with the

plants and advise you on a planting arrangement. Each themed planting plan comes in a 5m x 2m package. The plants and a detailed plant list are delivered direct to your door from the nursery.

Generally we use larger plants within these packages so that the effect is more instantaneous but we do advise that in the first 1-2 years the look will still be developing and will begin to mature after this period.

- 3.** Lastly, if you simply want a small number of plants, for example a couple of Buxus pyramids to frame your front door or would like a specific list of the plants you already have in mind, we can provide you with these at a fantastic price. No job is too large or too small. Just speak to a member of staff to see how we can help.

Garden Designers and Landscapers

We also cater for the professional gardener, with thousands of different plant varieties available and can help source specific or extraordinary plants. Remember we can order all your planting requirements and deliver them direct to site.

An example of a Mediterranean planting package...

Strong terracotta colours, brightly coloured walls and patio living can be enhanced by the addition of plants. Introduce tall Cupressus, Bay trees and shrubs, perfume of Jasmine, pungent tang of herbs and the fresh new growth of the vine. A sensual, exotic experience in your own back garden!!

The planting package contains:

- Cupressus arizonica 'Glauca'
- Laurus nobilis - Pyramid
- Yucca
- Lavendula
- Perovskia
- Vitis Coignetiae
- Salvia x superba
- Lemon Thyme
- Phormium
- Lavatera
- Cytisus
- Ceanothus
- Jasminum
- Oreganum

Total Price £499

	Number on plan	Size	Quantity
Trees			
Cupressus arizonica 'Glauca'	1	80-100cm	2
Laurus nobilis - Pyramid	2	125-150cm	1
Shrubs			
Phormium	3	3L	2
Yucca	4	30-40cm	1
Lavatera	5	2L	1
Lavendula	6	1.5L	5
Cytisus	7	3L	1
Perovskia	8	2L	3
Ceanothus	9	3L	1
Climbers			
Vitis Coignetiae	10	1.5L	1
Jasminum	11	2L	1
Herbaceous			
Salvia x superba	12	2L	3
Oreganum	13	2L	5
Lemon Thyme	14	1L	10

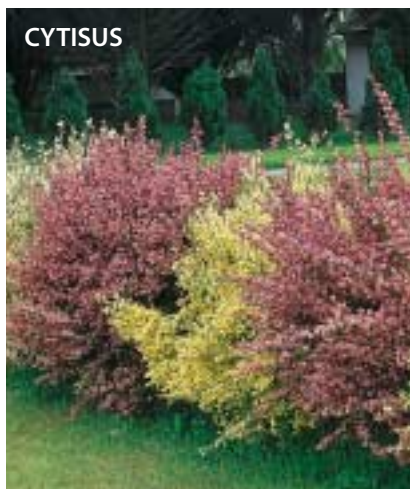
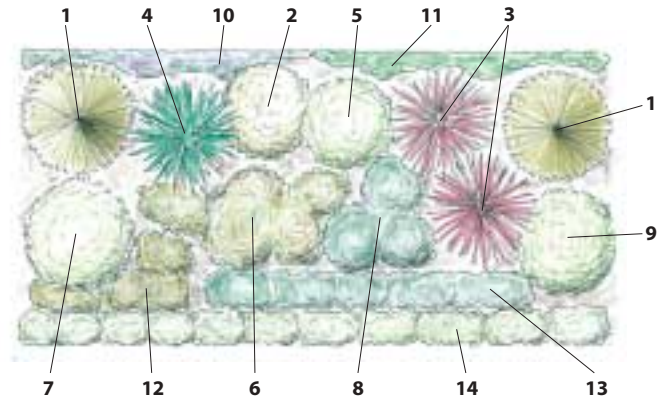

An overview of the other planting plans available from The Garden Studio:

Sanctuary Garden

Ideal for a shady spot. Designed with mainly evergreen plants, it will look great at most times of the year and will create interest through leaf texture and plant structure - a peaceful haven.

Contemporary Garden

Very low maintenance - designed for busy people! Planting to complement bold modern garden architecture and enhance the vertical effect of the garden patio.

Chic Garden

A great way to make a statement. Contemporary, fragrant, evergreen and easy.

Leisure Garden

For the garden user who wants to spend time outside, enjoying the benefits of the garden but with as little effort as possible! Here the plants enliven and brighten – bringing fun to parties and relaxation to patio lounging!

Oriental Garden

For those looking for a contemplative space, we have created a simple, elegant selection of plants that offer a calming effect on the senses.

Hi-Tech Garden

Strong, bold plants that will create a magical effect when spot-lit in an evening or when bathed in summer sunlight.

Play Garden

Tough plants for tough customers!! With bikes and footballs in mind, we've picked hardy plants that will also give year round interest and bring wildlife into the garden too.

Accessible Garden

An ideal collection for raised beds – allowing those who are finding it harder than it used to be to keep on gardening!! A selection of fragrant and tactile plants that will give months of colour and aromas.

All garden packs come with a full planting guide. Each plant is clearly marked and has a label suggesting the best position for it in the garden, both for maximum effect but also making sure that the smaller plants are not swamped behind taller types!

PLANTING BASICS

DECORATIVE BARK

100 Litres **£4.99** 100312
1.3 tonne bag **£149** 100311

MULTI-PURPOSE COMPOST

150 L **£5.99** 102035
1 tonne bag **£149** 101803

TOP SOIL

25 Litres **£2.99** 100439
1.15 tonne bag **£79** 100725

WEED CONTROL FABRIC

(W)1.5m
Black
£0.99/m 102650

WOVEN WEED CONTROL FABRIC

(W)2m
Black
£1.99/m 102651

PERFORMANCE WEED CONTROL FABRIC

(W)1.5m
Brown
£1.99/m 103232

VERDEGRASS ARTIFICIAL GRASS

(W)2m
£19.99/m 100070

SUPER VERDEGRASS ARTIFICIAL GRASS

(W)2m
£39.99/m 100237

VERDELUXE ARTIFICIAL GRASS

(W)2m
£59.99/m 100044

TURF

SS3 Ryegrass
£2.49/m² 101763

SS1 Bent & Fescue
£3.49/m² 102274